

inpro

atut



The ATUT residential estate is being developed at Zaczarowana Street in Rotmanka, very close to Pruszcz Gdański and just 10 km from the central part of Gdańsk.

-  School
-  Playgroup
-  Crèche
-  Bus stop
-  PKP railway station
-  Tri-City bypass road
-  Shops/market places
-  Seasonal farm
-  Cycling paths
-  Town relaxation complex

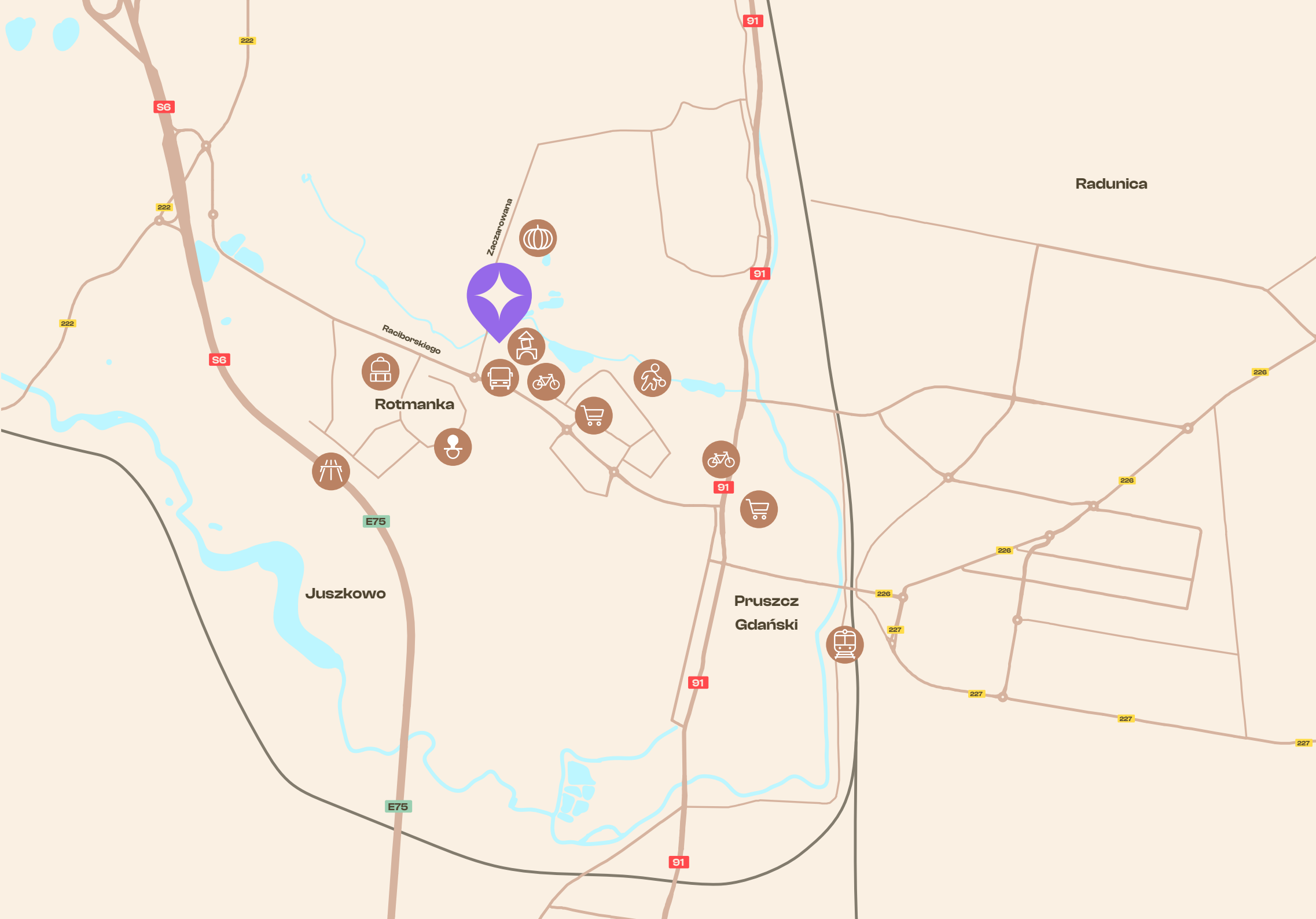



The estate has many attractive amenities which, taken together, create a unique space offering the residents access to what is important every day. Literally at your fingertips!

Advantages of the estate:

- relaxation area by the pond,
- nearby walking and cycling infrastructure,
- outdoor gym,
- multi-purpose sports field,
- playground,
- viewing deck,
- recreational shelter,
- community garden,
- playgroup and commercial units within the development.

All of this guarantees residents the opportunity to spend their free time exactly the way they like. After all, ATUT is not just a place to live, but to live on your own terms.

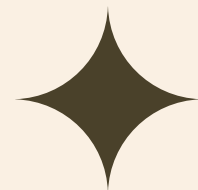



Additional relaxation space

Each flat will have additional space. Balconies are planned on the upper floors and private home gardens for the ground floor flats. Owing to that solution, the residents will be able to relax out of doors, without leaving their homes.



Playgroup at the estate

Being a parent is quite a challenge, which is why the ATUT estate provides various amenities to help carers with their daily chores. One of the amenities is a modern playgroup.



**Family-friendly
space**



The building in which the modern playgroup will be located.



Obviously, there will also be a space created with the children's free time in mind, which is an attractive and safe playground.

A sound mind in a sound body!

Everyone knows that an active body is a healthy body! That is why the ATUT estate is designed to encourage physical activity. To the delight of both younger and slightly older residents, the estate will feature a multi-purpose sports field suitable for various team games, as well as an outdoor gym.



Relaxation in natural surroundings

For all those who enjoy spending time out in nature, a pond surrounded by greenery, a plant-filled rain garden or a community garden which may be used for growing flowers and vegetables, may be ideal.





A commercial zone just a stone's throw from your home

As part of the ATUT, commercial units are planned, owing to which the residents will have access to daily services at their fingertips.



Practical details to make your life better

What is a guarantee of comfort? Functionality! For that reason, the buildings feature many amenities such as lifts, pram and bicycle rooms, as well as storage lockers.



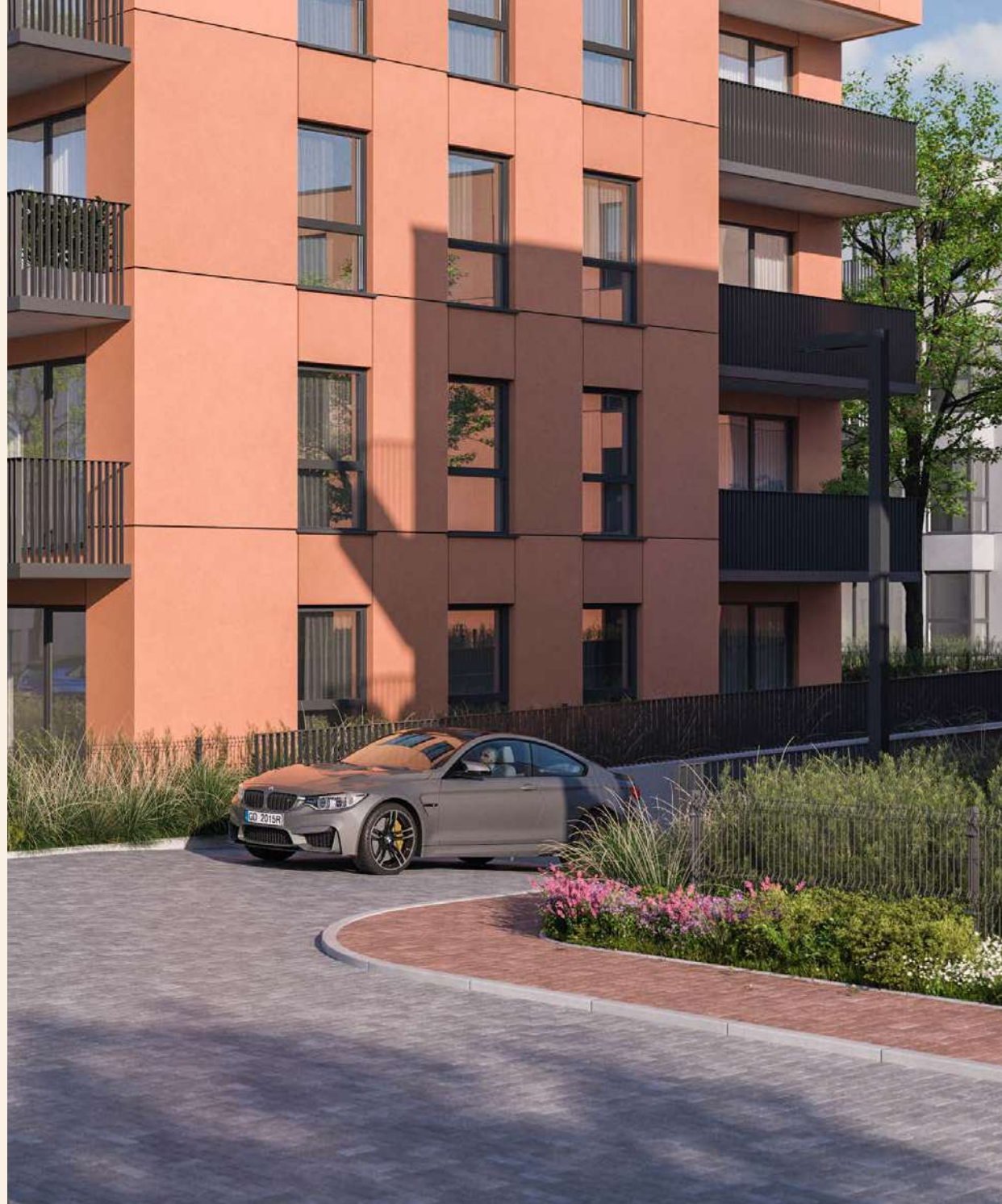

A garage hall located at level -1 will be an asset for the residents. In addition, the project will comprise ground-based parking spaces located at the common area. Electric vehicle charging stations will also be available within the development.

An offer tailored to your needs

A single person looking for his or her first-time flat, a young couple wishing to finally move into “their own home” or perhaps an elderly married couple planning to exchange their current flat with a slightly smaller one? ATUT is a space tailored to your needs and capabilities!

Small flats in an excellent location are also a great opportunity for investors seeking attractive rental properties. Our offer includes two room flats that can be purchased at prices starting from as low as PLN 340,000 with VAT!

Choose the ATUT and make your dream about your own home come true!



Quality, comfort and safety

Attention to details has been paid in the design of modern corridors, which will be made with the highest quality materials.



In addition, to provide the residents with a sense of security, the estate area will be illuminated and its key areas will be covered by the security surveillance system.





High quality will also be seen in the external common parts of the project, which will feature, for example, many structural landscaping items such as benches or bicycle stands, as well as unique relaxation and integration venues such as recreational shelters or the viewing deck.

Cycling and walking infrastructure

In the surroundings of the water reservoir in Pruszcz Gdański, near the ATUT project, recreational infrastructure has been provided including a cycling path and foot pavement, along with lighting and structural landscaping.



Credit support

In response to your expectations, we offer the opportunity to receive advice from experienced and competent credit experts. Their goal is to select the best financial product, minimize credit costs, and reduce the approval waiting time. Our experts are the top class experienced specialists, who know both the mortgage credit and real estate markets, and represent only your interests in relations with banks.

Credit support is completely free.

✉ magdalena.reysowska@inpro.com.pl

☎ 607 085 323



Turn-key flats

For those who value comfort, quality, and time, we offer the flat "turn-key finish" programme. This comprehensive programme guarantees an efficient and hassle-free flat finish. The owner doesn't need to be involved in renovation or finishing work and can move into a fully furnished home. A wide and diversified offer is a guarantee of the high quality of interior finish within the budget adjusted to the customer's needs.

✉ biuro@smlstudio.pl

☎ 607 200 189

🌐 www.smlstudio.pl

S.M.L
STUDIO

